

## Please read this manual before using

Thank you for purchasing a MUTOH product.

This manual explains the steps for unpacking, mounting and basic installation before using the MUTOH Full-color inkjet printer RJ-900X series.

This manual is intended for owners, installers, and users of this product.

Understand the contents and instructions in this manual before installing this product.

## Installation flow chart

The broad steps for installation are shown below. Follow the instructions beginning on the next page.

### NOTE

- The stands are optional depending on the product and regions.

## 1 Unpacking boxes

### 1.1 Unpacking the printer box

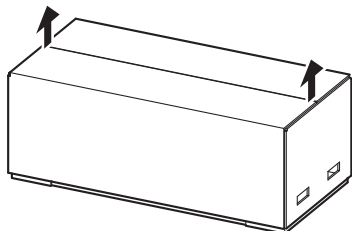

### 1.2 Unpacking the stand box

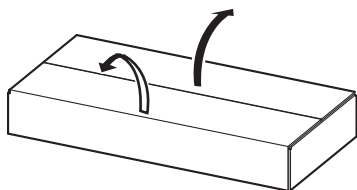

## 2 Confirming bundled items

- 2.1 Items in the printer box
- 2.2 Items in the attachment box
- 2.3 Items in the stand box

## 3 Assembling

### 3.1 The stand assembling procedure

### 3.2 Assembling the stand

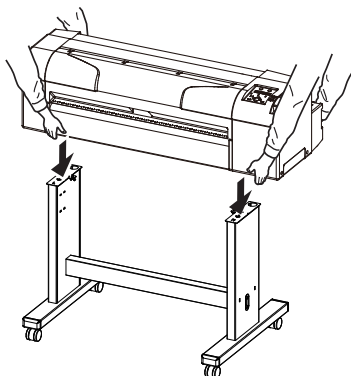

### 3.3 Detaching protective materials

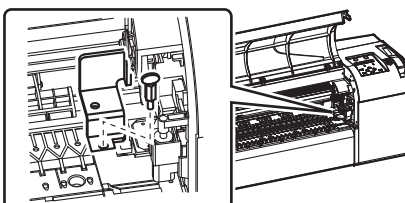

## 4 Installation

### 4.1 Installation environment

### 4.2 Installation procedure

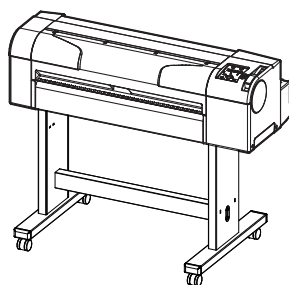

When using the printer only

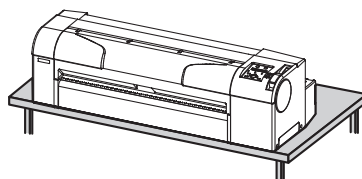

## 5 Connecting the power cable

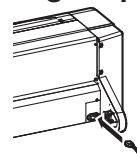

## 6 Turning the power ON/OFF

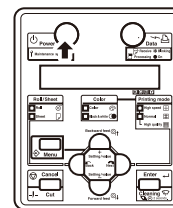

## 7 Activating the printer

## 8 Setting the display language

## 9 Installing the ink cartridge

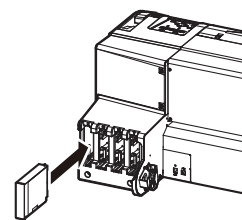

## 10 Loading the media

### 10.1 Loading the roll media

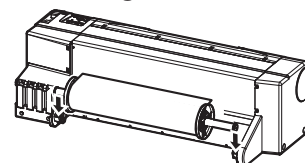

### 10.2 Loading the sheet media

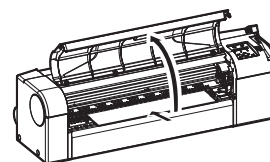

## 11 Check the printing condition

## 12 Installing the printer driver

## 13 About printer driver

## 14 Manual composition

## 1 Unpacking boxes

Procedures for unpacking boxes are explained. This product is packaged separately, divided into the printer and the stand.

### CAUTION

• **Unpacking this product requires the following number of people.**

- **RJ-901X : Two or more**
- **RJ-900X : Three or more**

• **While taking out the printer from the box, make sure to remove the vinyl sheet**

### 1.1 Unpacking printer box

Unpack the printer box in accordance with the following steps.

1. Carry the box to where you will unpack it.
2. Remove the bands.
3. Open the box and take out the following components.
  - Installation Manual (this manual)
  - Attachment box
  - Scroller

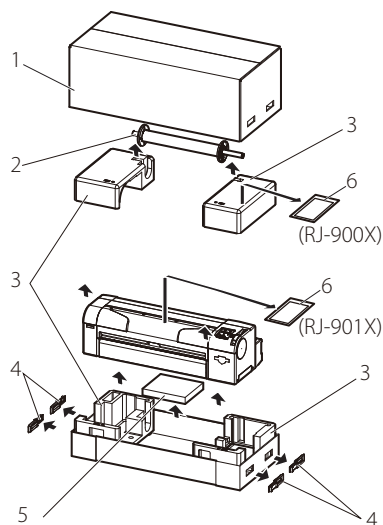

No.	Name	No.	Name
1	Printer box	4	Handles (RJ-901X only)
2	Scroller	5	Attachment box
3	Packing material	6	Installation Manual (this manual)

### 1.2 Unpacking stand box

Unpack the stand box in accordance with the following steps.

1. Carry the box to where you will unpack it.
2. Open the box and take out the components.

## 2 Confirming bundled items

After unpacking, please confirm that the product has not damaged and no components are missing.

### NOTE

• If any items are damaged or missing, contact MUTOH local dealer.

### 2.1 Items in the printer box

(1) RJ-901X

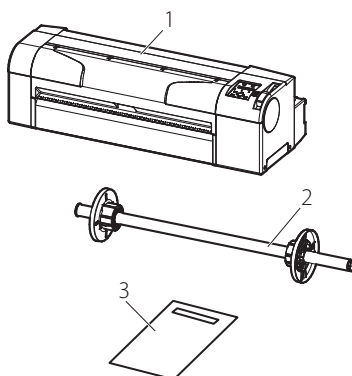

No.	Name	Q'ty
1	Printer main body	1 set
2	A1 Scroller 2 inch	1
3	Installation Manual (this manual)	1

(2) RJ-900X

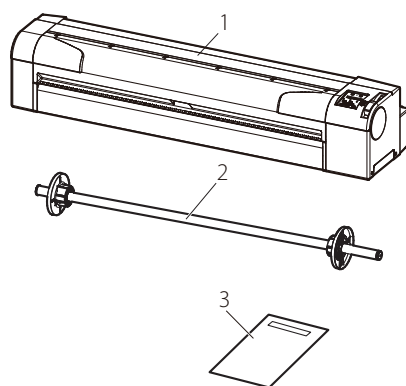

No.	Name	Q'ty
1	Printer main body	1 set
2	A0 Scroller 2 inch	1
3	Installation Manual (this manual)	1

### 2.2 Items in the attachment box

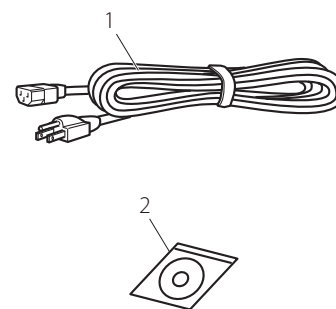

No.	Name	Q'ty
1	Power cable	1
2	Drivers and Manuals CD-ROM	1

### 2.3 Items in the stand box

#### NOTE

• The stands are optional depending on the product and regions.

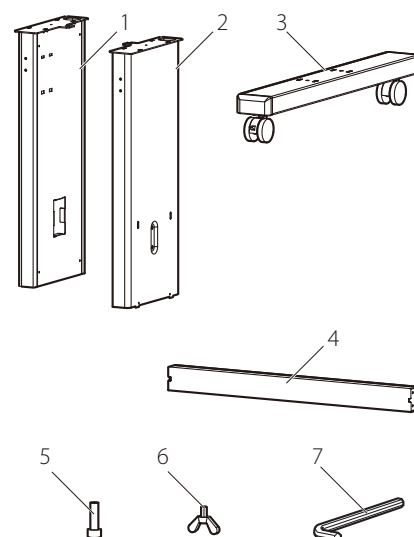

No.	Name	Q'ty
1	Left support	1
2	Right support	1
3	Caster section (left, right)	2
4	Central beam	1
5	Hexagon socket head cap screw	8
6	Butterfly bolt	2
7	Hexagonal wrench	1

### 3 Assembling

Procedures for assembling this product are explained.

#### CAUTION

- **Unpacking this product requires the following number of people.**
- **RJ-901X : Two or more**
- **RJ-900X : Three or more**

#### 3.1 The stand assembling procedure

If you will use the stand, assemble it in accordance with the following steps.

- Follow the steps shown below to assemble the right side of the stand.
  - Install the (right) support to the leg so that the caster with the lock is on the front.
  - Fasten two hexagon socket head cap screws with the enclosed hexagonal wrench.

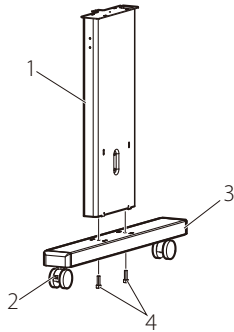

No.	Name	No.	Name
1	Right support	3	Caster section
2	Caster lock	4	Hexagon socket head cap screws

- Assemble the left side of the stand in a similar way to step 1.

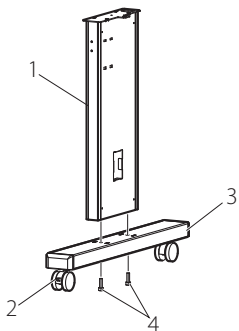

No.	Name	No.	Name
1	Left support	3	Caster section
2	Caster lock	4	Hexagon socket head cap screws

- Follow the steps shown below to attach the central beam to the legs (left, right).
  - Attach the central beam and four hexagon socket head cap screws to the stand (the left, the right).
  - Fasten the hexagon socket head cap screws with the enclosed hexagonal wrench, and fasten the central beam.

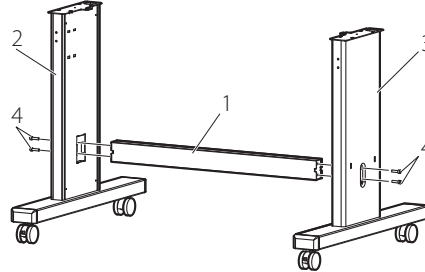

No.	Name	No.	Name
1	Central beam	3	Leg (right)
2	Leg (left)	4	Hexagon socket head cap screw

- Attach two arm holders to the legs (left, right).
- Confirm that each component is fastened firmly by gently shaking the stand.

#### 3.2 Assembling the stand

Attach the stand to the printer in accordance with the following steps.

- Lock two casters on the front side.

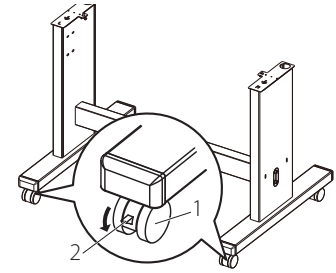

No.	Name	No.	Name
1	Casters	2	Caster locks

- Lift the printer main body, and align the rear side rubber feet to the holes of the stand.

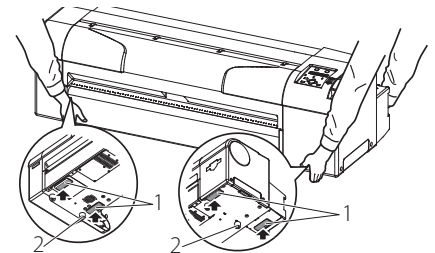

No.	Name	No.	Name
1	Grips	2	Rubber feet

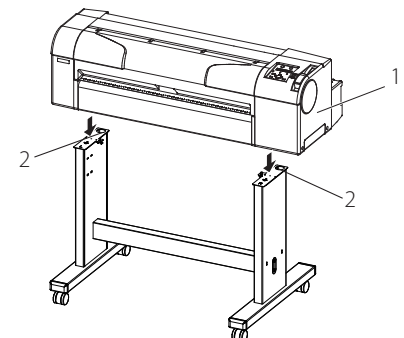

No.	Name	No.	Name
1	Printer main body	2	Holes of the stand

- Attach two butterfly bolts to the stand.
- Secure the printer to the stand by bolting the butterfly bolts.

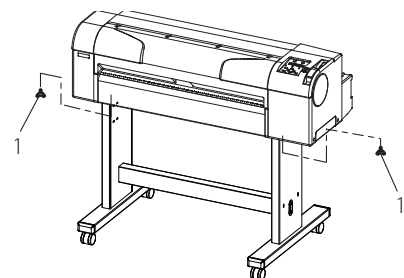

No.	Name
1	Butterfly bolts

- This completes assembling of the stand.

### 3.3 Detaching protective materials

This product has protective materials in the place shown below.

Detach all protective materials in accordance with the following steps.

1. Remove all tapes from each cover.
2. Open the front cover and unscrew the butterfly screws, and detach the fixing head unit protective materials (metal plate).

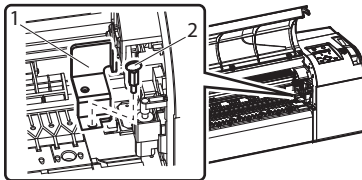

No.	Name	No.	Name
1	Fixing head unit protective materials (metal plate)	2	Butterfly screw

- This completes detaching protective materials.

## 4 Installation

Procedures and environment for installing this product are explained.

### 4.1 Installation environment

Install this product to the appropriate place with reference to the following.

#### ⚠ WARNING

- Do not install the printer in the following places where there is a possibility that the printer may be damaged or might fall or be fallen by chance.
  - On a shaky stand
  - Slanting location
  - Places where vibration of other machines etc. is transmitted.
- Do not stamp on the printer or do not place heavy things on top of it. It may cause an injury if the printer falls down.
- Cover the printer with blanket and cloth like tablecloth and do not close the vent. If the vent is closed, the printer could accumulate heat inside and may cause fire.
- Do not install the printer in a location that has high humidity or is dusty. It could lead to electric shock and fire.

#### 4.1.1 Installation environment

Select an installation location in accordance with the table below.

Floor strength of installation place		More than 2940 Pa (300 kg/m <sup>2</sup> )
Power Specification	Power Supply	AC90V - 132V/198V - 264V
	Frequency Range	50/60Hz ±1Hz
	Power capacity	More than 10 A
Environmental conditions	Operative condition	Temperature: 10 °C- 35 °C Humidity: 20 % - 80 %, No Condensation
	Guaranteed range of printing accuracy	Temperature: 15 °C - 28 °C Humidity: 40 % - 60 %, No Condensation
	Change rate	Temperature: within 2 °C per hour Humidity: within 5 % per hour

#### NOTE

- For temperature and humidity, avoid locations such as the following. There is a possibility that the print quality will be affected.
  - Places where temperature or humidity may rapidly change, even though within the required conditions.
  - Place that receives direct sunlight or strong illumination light
  - Place that receives direct wind from an air conditioner, and so on
- To keep the temperature and humidity constant, install this product in a location where the air condition is adjustable.

### 4.1.2 Installation space

- **When using the printer with the stand**  
Install on a level floor which meets the following condition.

- It has enough strength to support the weight of the printer and the stand.

#### NOTE

- For the weight of the printer and the stand, refer to the Operation Manual.

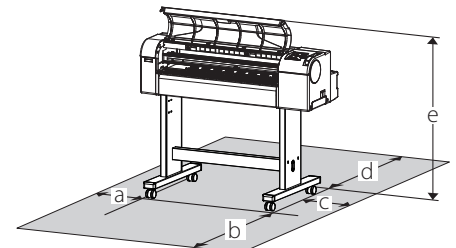

RJ-901X	RJ-900X
a=180mm	a=180mm
b=450mm	b=450mm
c=480mm	c=480mm
d=300mm	d=300mm
e=1198mm	e=1198mm

- **When using the printer only (RJ-901X)**

Install on a level table that meets the following conditions.

- The table has enough strength to support the weight of the printer.

#### NOTE

- For the weight of the printer, refer to the Operation Manual.

- The required length for the sheet media is available in the back.
- The height from the floor is 600 mm to 800 mm.
- The space in the front is more than 300 mm.
- Printed sheets are not folded or dirtied.

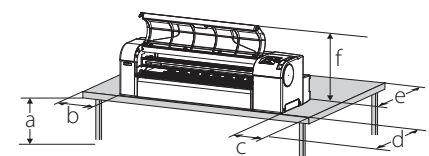

a=600-800mm
b=100mm
c=300mm
d=300mm
e=500mm
f=567mm



## 4.2 Installation procedure

Install this product to the installation place in accordance with the list shown below.

### 4.2.1 When using the printer with the stand

#### NOTE

- Please check that the butterfly bolts are not loose before/after carrying this product. When transferring or carrying outside, separate the printer and the stand.

1. Check that the two butterfly bolts attaching the stand and the printer are not loose.
2. Carry the printer to the installation place.
3. Lock two casters on the front side.

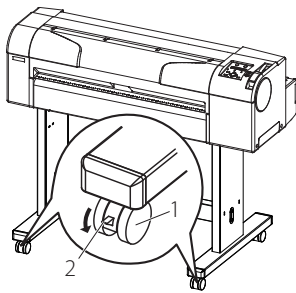

No.	Name	No.	Name
1	Casters	2	Caster locks

4. Check that the two butterfly bolts attaching the stand and the printer are not loose.

### 4.2.2 When using the printer only (RJ-901X)

1. Install the printer so that the rubber foot (front) of the product is placed on the front of the board.

#### NOTE

- When using the printer only (without the stand), always arrange as shown below. There is a possibility that the printed sheets are affected or errors such as media jams occur.

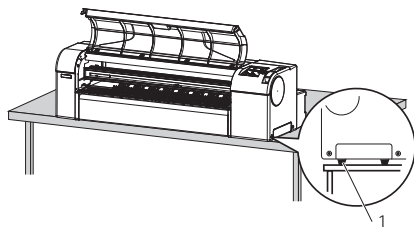

No.	Name
1	Rubber feet

## 5 Connecting the power cable

This section explains how to connect the power cable. Follow the steps below to connect the power cable.

#### ⚠ WARNING

- Be sure to use the specified power cable. Using a power cable other than the specified can cause an electric shock or fire.
- Use the power cable compliant with the safety standards, power-supply voltage, and plug shape of the country where the printer is used.
- Use a power cable which is equipped with a protective earth, and securely connect it to the outlet.
- Do not use a damaged power cable. It could lead to an electric shock or fire.

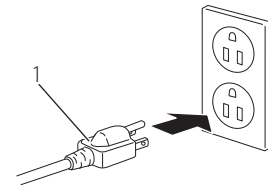

No.	Name
1	Power cable

1. Confirm that the product is turned OFF.

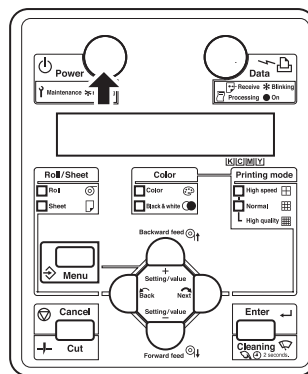

2. Connect the power cable to the AC inlet on the back of the product.

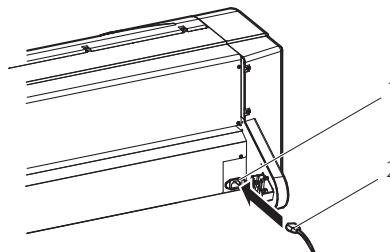

No.	Name	No.	Name
1	AC inlet	2	Power cable

6 Turning the power ON/OFF

This section explains how to turn the printer ON/OFF.

6.1 Turning the power ON

Follow the procedure below to turn the power ON.

- 1. Press the [Power] key on Operation panel to turn ON the printer.
- Power lamp on Operation panel lights up in blue.

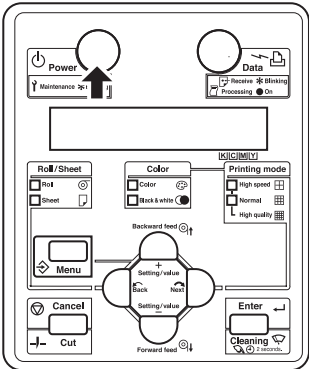

- The printer starts the initial operation.
- When the initial operation is complete, the printer enters the Normal condition.

6.2 Turning the power OFF

Follow the procedure below to turn the printer OFF.

- 1. Verify the following regarding the operational condition of the printer.
  - Printing or other operations are not in progress.
  - Operation panel display is Normal.
- 2. Press the [Power] key on Operation panel to turn OFF the printer.
  - Power lamp on Operation panel turns OFF.

NOTE

- If Operation panel is in the following status, the power is ON.
- The [Power] key is pressed in.
- Power lamp is ON.

Press the key once again to turn the power OFF.

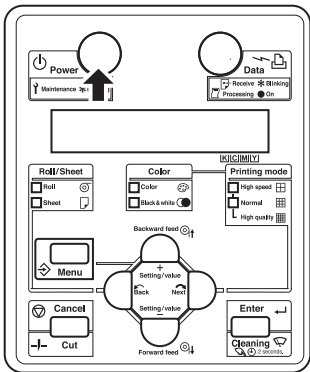

- The printer turns the power OFF.

NOTE

- When the media is set, "Lift the lever" is displayed on Operation panel. Raise Media loading lever.

- "Wait for a while..." is displayed on Operation panel.
- All the lamps on Operation panel and the LCD monitor are turned OFF.
- The printer automatically turns the power OFF.

NOTE

- After turning OFF the printer, wait for ten seconds or longer to turn it ON again.

- 3. If you are not using the printer for a long time, raise Media loading lever.

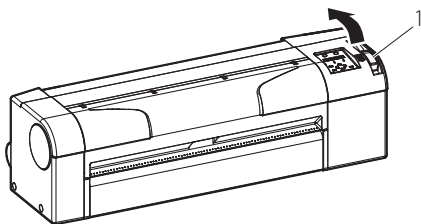

No.	Name
1	Media loading lever

7 Activating the printer

This product requires activation when the power is turned ON for the first time.

When "Activation required" is displayed on Operation panel, follow the "Printer activation guide"\* and perform activation.

\*Download the "Printer activation guide" from the following ValueJet Club.

<https://mbss.mutoh.co.jp/mutoh/guser/>

## 8 Setting the display language

After activation is complete, you need to make the language setting when restarting the product. Follow the procedures below to make setting.

- Once activation is complete, "Reboot a printer" is displayed on Operation panel. Press the [Power] key on Operation panel and turn OFF the printer.

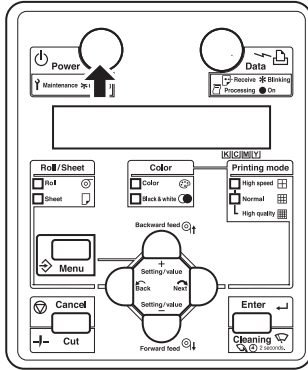

- Press the [Power] key on Operation panel to turn ON the printer.

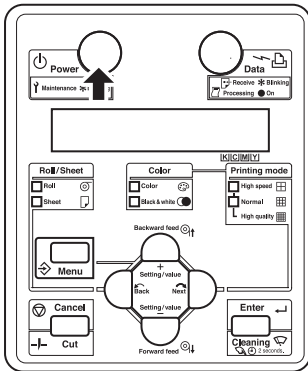

- "Language: Japanese" is displayed on Operation panel.
- Press the [Enter] key.
    - Press the [+] key or [-] key on Operation panel to select a setup item and press the [Enter] key.

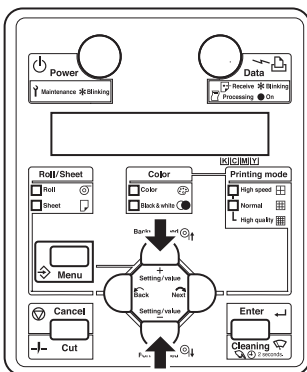

- This completes the setting of display language.

- The printer starts the initial operation.
- When the initial operation is complete, the printer enters Normal.

## 9 Installing the ink cartridge

This section explains about how to install the ink cartridge. Follow the steps below to install the ink cartridge.

### NOTE

- While handling ink cartridges, be careful that the ink does not come into contact with your eyes or skin. If the ink got into your eyes or attached to the skin, immediately wash with water. Failing to do so may cause irritation and light inflammation of the eyes. In case of any abnormality, consult a physician immediately.

- Turn ON the product.
- The product starts the initial operation.
  - The operation panel displays "No ink cartridge \*\*\*\*"
- Take out the ink cartridge from the bag.
- Install the ink cartridge into the ink cartridge slot.
  - Insert the ink cartridge into the product with mark upside.

### NOTE

- Insert the ink cartridge all the way to the end of the slot.
- Insert all four ink cartridges.
- Make sure that the ink cartridges are inserted into the correct slots. Match the mark in front of the slot and the color of the ink before inserting the ink cartridge.
- Ink cartridges are structured to avoid wrong insertion. If you cannot insert the ink cartridges into the slot smoothly, you may be inserting it into a wrong slot. Do not insert it forcefully.

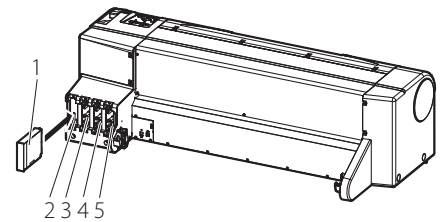

No.	Name	No.	Name
1	Ink cartridge	4	Ink cartridge slot M
2	Ink cartridge slot K	5	Ink cartridge slot Y
3	Ink cartridge slot C		

5. "Ink Refill \*\* min" is displayed, and the ink starts the Initial ink charge.
- It takes about 5 minutes. In the initial operation, the product repeats ink filling and pausing.

### CAUTION

- Comply strictly with the following during ink filling.
  - Do not turn the printer OFF.
  - Do not unplug the power cord set of the printer.
  - Do not open the front cover.
  - Do not open the maintenance cover.
  - Do not raise the media loading lever.

6. If the ink finishes being filled, the operation panel displays "Paper End".

### NOTE

- If the paper is printed just after the initial filling, the following conditions may occur.
  - The printed line is blurred.
  - The white line appears on the prints.

In such cases, refer to the following to refill a small amount of ink, and then check the printing result.

☞ Operation manual "5.2.3 Head Cleaning"

- If there is no improvement in the print result even after refilling a small amount of ink, leave the printer unused for an hour or more. Then, refill a small amount of ink again and check the print result. If the print result still remains the same, contact the following.

☞ Operation panel "7.4.2 Technical Support"

## 10 Loading the media

### 10.1 Loading the roll media

This section explains about how to load the roll media.

Put the roll media in the center of the printer.

Follow the steps to load the media.

1. When using roll media of three-inch diameter media tube, the optional three-inch attachment should be used to the movable flange and fixed flange.

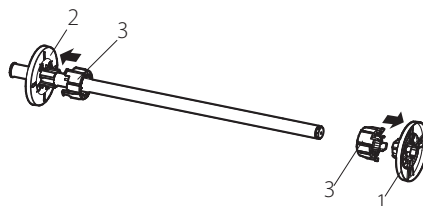

No.	Name	No.	Name
1	Movable flange	3	Three-inch attachment
2	Fixed flange		

2. Load the roll media into the scroller so that the roll media gets wound up in the anti-clockwise direction in the view from the fixed flange side.

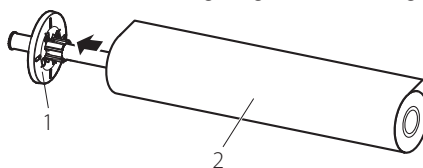

No.	Name	No.	Name
1	Movable flange	2	Roll media

3. Push the roll media completely until the roll media core hits the right edge of the fixed flange.

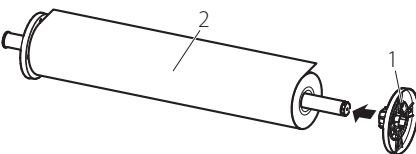

No.	Name	No.	Name
1	Movable flange	2	Roll media

4. Attach the movable flange until it firmly sticks to the roll media core.

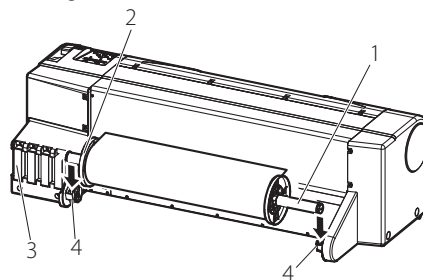

No.	Name	No.	Name
1	Scroller	3	Ink cartridge slot
2	Fixed flange	4	Scroller receiver

6. Turn ON the product.
- The product starts the initial operation.
  - The operation panel displays "Paper End".

7. Select "Roll media" by pressing [ 前 ] key on the operation panel.
- Roll media lamp lights up.

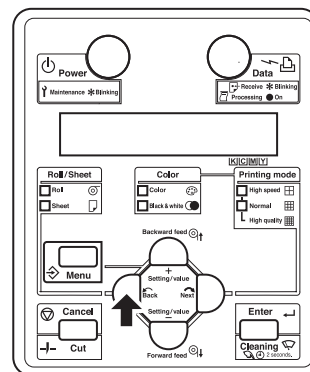

8. Push the media loading lever backward.
- The operation panel displays "Lever Up".

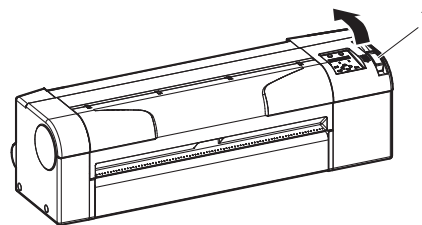

No.	Name
1	Media loading lever

9. Feed the roll media into the media feed slot.

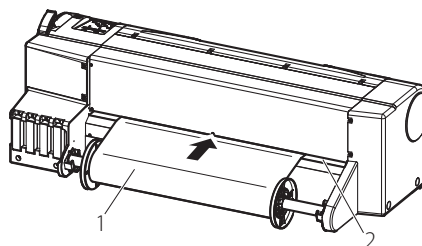

No.	Name	No.	Name
1	Roll media	2	Media feed slot

10. Open the front cover, and pull out the roll media.

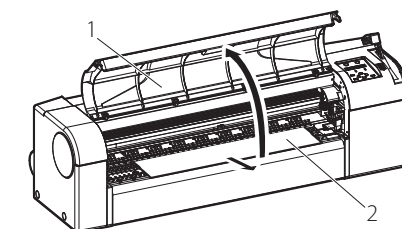

No.	Name	No.	Name
1	Front cover	2	Roll media

11. Wind back the roll media with scroller while pressing down the media edge, remove bending and slant of the media.

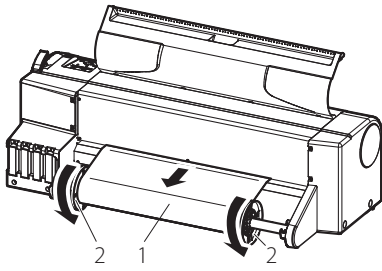

No.	Name	No.	Name
1	Roll media	2	Scroller

12. Return the media loading lever to your front, and close the front cover.

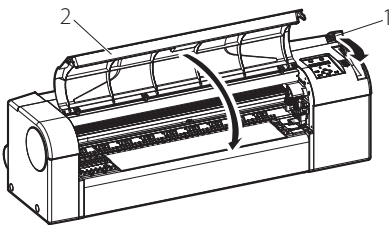

No.	Name	No.	Name
1	Media loading lever	2	Front cover

- The operation panel displays the media type setup menu.

13. Press the [Setting value +] key or [Setting value -] key on the operation panel, and enter the selected number.

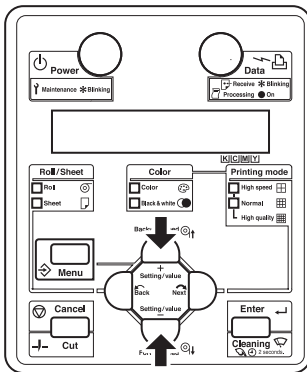

- The media type is entered.
- The operation panel displays "Paper Initial", and media starts the initial operation.
- After finishing the media initial operation, the operation panel displays "Ready to Plot", and the product turns to a normal operation.

14. Wind back the roll media with scroller to remove bending and slant of the media.

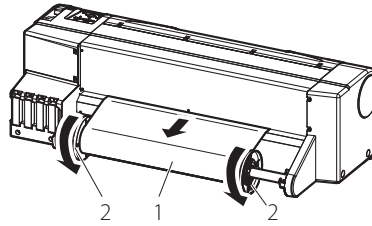

No.	Name	No.	Name
1	Roll media	2	Scroller

- The media loading is complete.

## 10.2 Loading the sheet media

This section explains about how to load the sheet media.

Follow the steps below to load the sheet media.

1. Turn ON the product.
2. The product starts the initial operation.
  - The operation panel displays "Paper End".
3. Select "Sheet media" by pressing [ 前 ] key on the operation panel.
  - Sheet media lamp lights up.

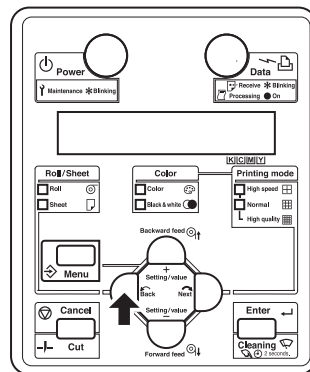

4. Push the media loading lever backward.
  - The operation panel displays "Lever Up".

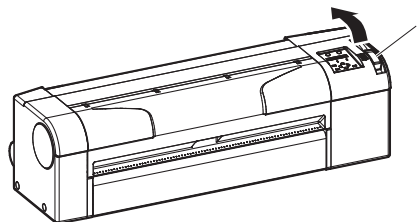

No.	Name
1	Media loading lever

5. Open the front cover, and insert the sheet media in to the media feed slot.

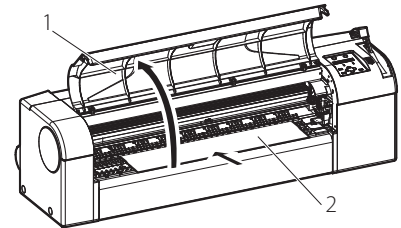

No.	Name	No.	Name
1	Front cover	2	Sheet media

6. Align the right end of media to the media loading mark, and align the front edge to the step of platen respectively.

### NOTE

- If the sheet media right end shifts either to the right or the left from the loading mark, it would become as media loading error without media being detected.
- Load the media within the  $\pm 5$  mm range from the loading mark.

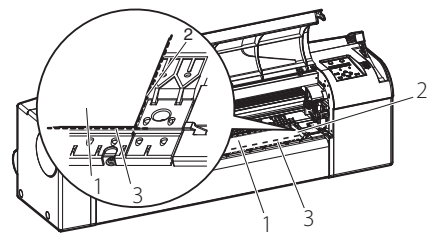

No.	Name	No.	Name
1	Sheet media	3	Step of platen
2	Media loading mark		

7. Return the media loading lever to your front and close the front cover.

- The operation panel displays the media type setup menu.

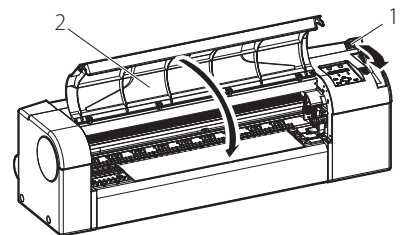

No.	Name	No.	Name
1	Media loading lever	2	Front cover

8. In the same way as step 13 in "10.1 Loading the roll media", make the media type setting.
- When the media type is entered, the operation panel displays "Paper Initial", and media starts the initial operation.
  - After finishing the media initial operation, the operation panel displays "Ready to Plot", and the product turns to a normal operation.
  - The media loading is complete.

## 11 Check the printing condition

Check the print head condition after ink initial filling.

1. Turn ON the power to the printer, and set A3 or larger sheet media or roll media.
10. Loading the media
2. Check that "Ready to Print" is displayed on Operation panel.
3. Press the [Menu] key on the operation panel.

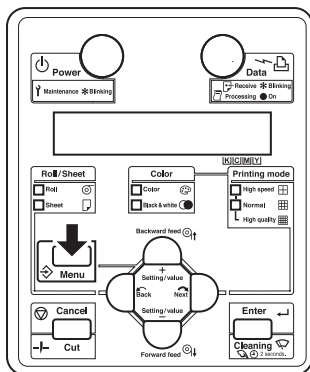

- "Menu\* TestPlot >" is displayed on the operation panel
  - Operation panel shifts to the Setup menu display.
4. Press the [Enter] key on Operation panel.

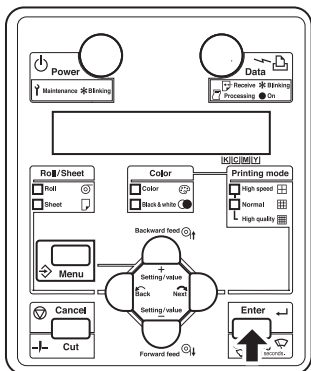

- "TestPlot: SetupPlot" is displayed on the operation panel
  - Display shifts to Test print menu.
5. Press the [Setting value +] key or [Setting value -] key on the operation panel, select "Nozzle check" and press the [Enter] key.
  - Perform the nozzle check printing.

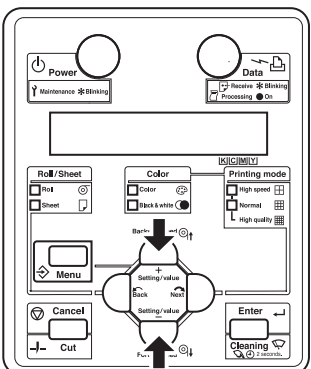

6. Check the print sample and confirm that the checked points are blurred or missing.

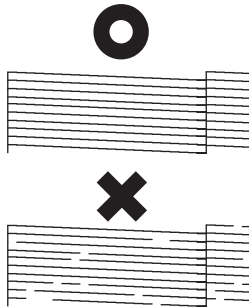

7. If the nozzle check result indicates that the checked points are blurred or missing, clean the head.
- Press the [Cleaning] key on the operation panel for at least 2 seconds.

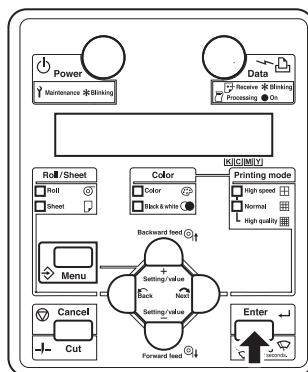

- "Cleaning \*\* min" is displayed on the operation panel.

8. Start head cleaning.

### NOTE

- If print blurs or incomplete printing is not fixed by one head cleaning, perform strong cleaning.
  - If several head cleanings does not remove print blur or incomplete printing, refer to the following and perform required procedures.
- ➡ Operation Manual "6 Troubleshooting"

9. Perform the nozzle check again, and confirm the print head condition.

## 12 Installing the printer driver

### 12.1 For network connection

This section explains how to connect to the Internet (TCP/IP).

1. Turn ON the power to the printer.
2. Set the IP address for the printer.

### NOTE

- For the procedure to set IP addresses, refer to "3.6.5 Setting IP Addresses" in the Operation manual.
- You can view the Operation manual from the CD-ROM ("Drivers and Manuals CD-ROM") included with the product.
  - The language preference screen is displayed when you start the CD-ROM. Click the language you want, and then click "Viewing the Operation manual" on the next screen.

3. Insert the network interface cable connector into the network interface connector located on the back of the printer.

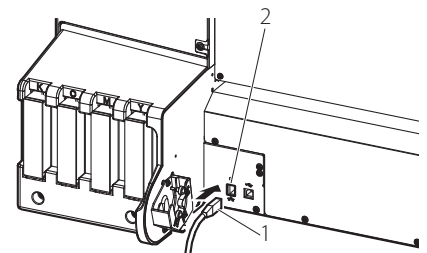

No.	Name	No.	Name
1	Network interface cable	2	Network interface connector

4. Fix the network interface cable to the cable clamp.

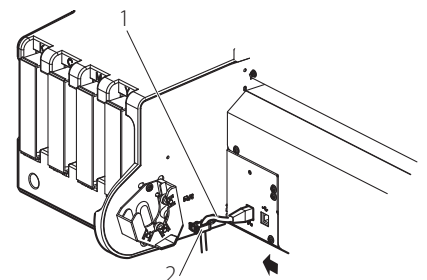

No.	Name	No.	Name
1	Network interface cable	2	Cable clamp

5. Connect the another network interface cable connector to the PC.
6. Turn ON the power to the PC.



7. Ensure that your PC boots up correctly, and insert the CD-ROM on which "Windows printer driver" is written into the CD-ROM drive on your PC.
  - The language preference screen is displayed.
8. Click the language you want to use.

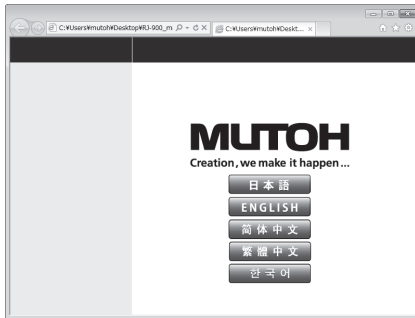

9. Click "Install the printer driver" on the next screen.

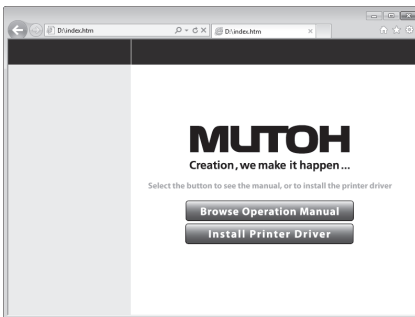

10. The installer starts up.

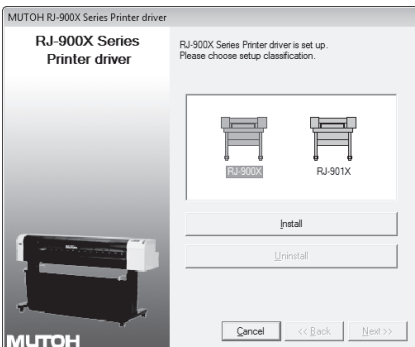

#### NOTE

- For the details of installation, refer to "3.7.2 Installation procedure of the printer driver (network connection)" in the Operation manual.

## 12.2 For USB connection

This section explains how to connect USB device.

#### NOTE

- Do not connect the USB cable before installing the printer driver. Otherwise the driver cannot be installed correctly.
- If you have connected the USB cable first by mistake, check "6.1.1.1 If You Connect USB before Installing Driver".

1. Turn ON the power to the PC.
2. Ensure that your PC boots up correctly, and insert the CD-ROM on which "Windows printer driver" is written into the CD-ROM drive on your PC.
  - The language preference screen is displayed.

3. Click the language you want to use.

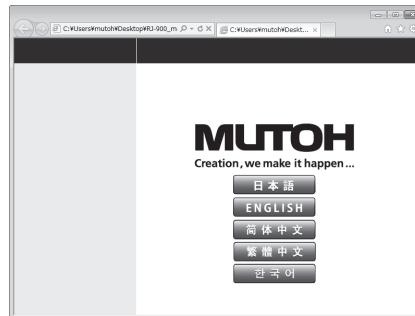

4. Click "Install the printer driver" on the next screen.

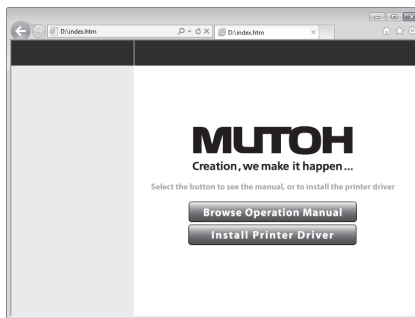

5. The installer starts up.

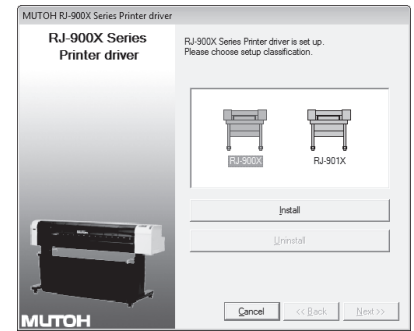

#### NOTE

- For details about installing, refer to "3.7.3 Installing the printer driver (for USB connection)" on the Operation manual.
- You can view the Operation manual from the CD-ROM ("Drivers and Manuals CD-ROM") included with the product.
  - The language preference screen is displayed when you start the CD-ROM. Click the language you want, and then click "Viewing the Operation manual" on the next screen.

### 12.2.1 Connecting the USB cable

1. Insert the USB cable into the USB connector on the back of the printer.

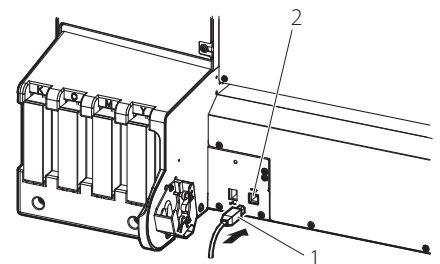

No.	Name	No.	Name
1	USB cable	2	USB connector

2. Fix the USB cable to the cable clamp.

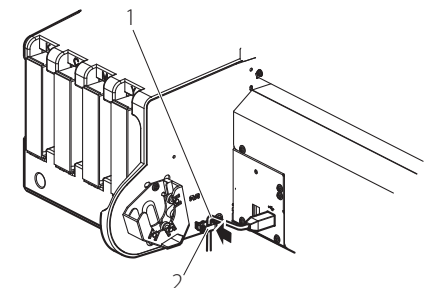

No.	Name	No.	Name
1	USB cable	2	Cable clamp

## 13 Printer driver

Printer driver is used to print and output the print data created with Windows application software to the printer.

### 13.1 Setting the printer driver

Follow the procedure below to configure the following items.

1. Selecting the printer driver
2. Setting the printer driver

#### NOTE

- For the setup procedure of the printer driver, refer to "4.4 Setting Printer Driver" in the Operation manual or the attached help file. The file will be displayed by clicking [HELP] on the printer driver setup screen.

## 14 Product Activation Guide

This product includes the following manuals.

#### • Installation Manual (this manual)

This manual explains the procedures of unpacking, installing, and basic set up.

#### • Product Activation Guide

This manual explains the operation procedure when you start the printer for the first time.

#### • Operation Manual (CD-ROM)

Operation Manual explains the basic installation, daily use and applicable functions.

#### NOTE

- Download the "Printer activation guide" from the following ValueJet Club.

<https://mbss.mutoh.co.jp/mutoh/guser/>

- You can view the Operation manual from the CD-ROM ("Drivers and Manuals CD-ROM") included with the product.

- The language preference screen is displayed when you start the CD-ROM. Click the language you want, and then click "Viewing the Operation manual" on the next screen.

- You can use a browser such as Internet Explorer to view the HTML page that's displayed to select the language when you start the CD-ROM.

- The Operation manual of this printer is a PDF format.

Adobe Acrobat Reader 5.0 or later is required to view a PDF file. You can download Adobe Reader from the Adobe web site for free.

# MUTOH

MUTOH INDUSTRIES LTD.  
Tel.:81-(0)3-6758-7020  
Fax:81-(0)3-6758-7025  
E-mail:ibd@mutoh.co.jp  
<http://www.mutoh.co.jp/en/index.html>

MUTOH AMERICA INC.  
Tel.:1-480-968-7772  
Fax:1-480-968-7990  
E-mail:sales@mutoh.com  
<http://www.mutoh.com>

MUTOH BELGIUM nv  
Tel.:32-(0)59-561400  
Fax:32-(0)59-807117  
E-mail:mutoh@mutoh.be  
<http://www.mutoh.be>

MUTOH DEUTSCHLAND GmbH  
Tel.:49-(0)211-385474-0  
Fax:49-(0)211-385474-74  
E-mail:vertrieb@mutoh-gmbh.de  
<http://www.mutoh.de>

MUTOH North Europe S.A.  
Tel.:352-445-906  
Fax:352-447-093  
E-mail:info@segroun.lu  
<http://www.segroun.lu/>

MUTOH HONGKONG LTD.  
Tel.:852-2377-3411  
Fax:852-2377-3422  
<http://www.mutoh.co.jp/en/index.html>

MUTOH SINGAPORE PTE.LTD.  
Tel.:65-6325-3150  
Fax:65-6220-4342  
E-mail:sales\_inq@mutoh-sg.com  
<http://www.mutoh.co.jp/en/index.html>

MUTOH AUSTRALIA PTY.LTD.  
Tel.:61-2-9437-1336  
Fax:61-2-9436-2871  
E-mail:sales@mutoh-au.com  
<http://mutoh-au.com>